

H&H

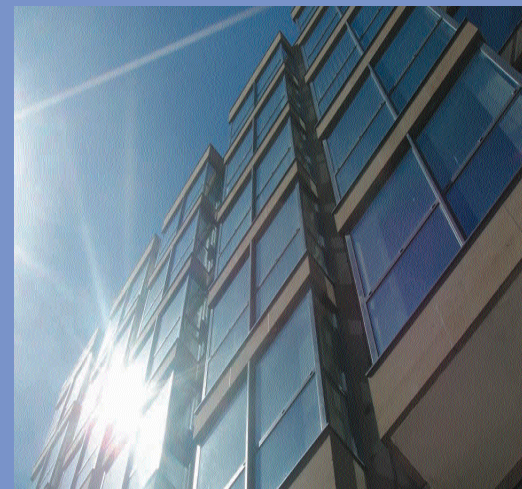

REDUC

Acoustic Flooring - H&H Acoustic Construction Division





REDUC



Hodgson & Hodgson Group Limited

Hodgson & Hodgson Group has been in existence for well over a century and has made its business out of noise control. The Group operates three complementary Divisions, H&H Acoustic Construction Division, H&H Acoustic Components Division and H&H Acoustic Consultancy Division across eleven UK locations; its objective, to provide a complete portfolio of high quality acoustic products and services, a "one stop shop" for solving the problems caused by unwanted noise.

The REDUC Range

REDUC acoustic flooring has a long history. Unlike many of its competitors, it was not brought to the market simply to capitalise on the 2003 amendment to Approved Document E of the building regulations. Instead, it has been developed as part of a continuing programme of research, development and innovation in order to provide optimum acoustic performance beyond set standards. Naturally, the products have been independently tested to demonstrate compliance with all current legislation, however, laboratory test results are no substitute for the practical results attributable to **REDUC** from the many millions of square metres laid over the years. It's no secret that **REDUC's** brand leadership and reputation reflect its pedigree. This emanates from a wealth of knowledge and experience gained by Hodgson & Hodgson's highly qualified acoustic engineers reinforced by the availability of their support from project conception right through to installation on-site.



Supporting Services

For major projects H&H Acoustic Construction Division can arrange a full installation service.

H&H Acoustic Consultancy Division is able to conduct noise surveys and calculate reverberation times pre and post installation. Telephone: 01473 824452. Highly qualified engineers are available for site visits and to offer advice and assistance to clients, architects and contractors on all aspects of noise control and current legislation to ensure specifications and acoustic performance requirements are achieved.

Don't Forget

H&H Acoustic Construction Division markets the full range of branded architectural noise control products.

-  **ECOMAX** for ceilings
-  **SALEX** for walls
-  **THERMOS** for building services

Consult Individual product summary brochures for further information.

The Products

This brochure is provided by way of an introduction to **REDUC**. For detailed technical information consult our website www.acoustic.co.uk where individual data sheets and installation guidelines are available for download, together with project case studies and NBS clause details. Alternatively, telephone 01664 821810.

REDUC Micro / REDUC Micro Extra

Minimal height overlay acoustic flooring for timber and concrete.

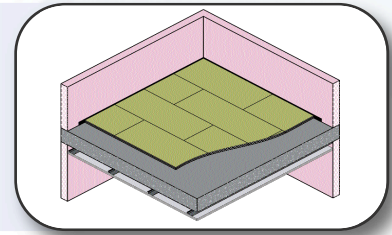

REDUC Strata / REDUC Strata Extra

Heavy duty overlay acoustic flooring for optimum performance.

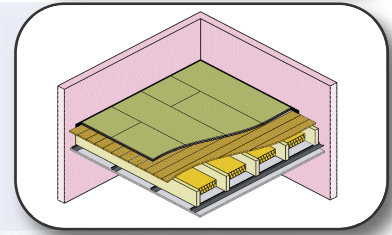

REDUC Foundation / REDUC Foundation Extra

Structural acoustic flooring designed for laying directly onto joists.

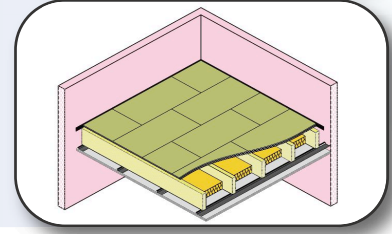

REDUC SoundFloor / REDUC SoundFloor Extra

For use within specialist applications such as underfloor heating systems, wet rooms and within cradle and batten systems. Further details on request.

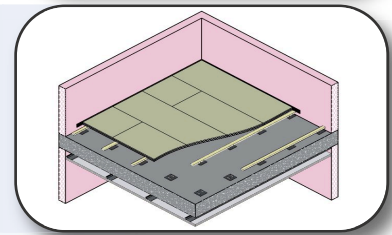

REDUC SoundMat

Acoustic underlay suitable for use with timber and concrete floors.

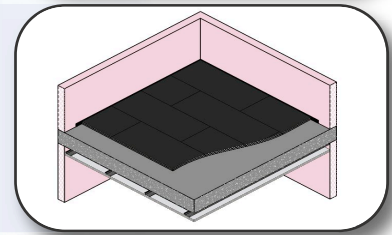

REDUC Impact

Resilient under screed sound insulation layer for new build applications.

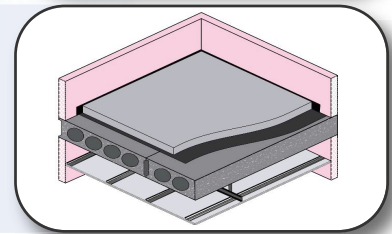

REDUC System Accessories

REDUC SoundSlab

High density mineral wool laid between joists for additional sound absorption.

REDUC SoundBreaker Bars

Isolation bars for improving the acoustic performance of floors.

REDUC FireFloor

System for achieving a one hour fire rating for intermediate floors.

Isolation tape, joint adhesive and acoustic sealant are available to complete the installation of REDUC acoustic flooring systems.



Dimensions and Weight

REDUC Product	Thickness mm	Length mm	Width mm	Weight kg/m ²
REDUC Micro	17	1175	575	9.10
REDUC Micro Extra	21	1175	575	18.00
REDUC Strata	35	1175	575	18.47
REDUC Strata Extra	35	1175	575	27.90
REDUC Foundation	35	2400	600	20.50
REDUC Foundation Extra	39	2400	600	23.60
REDUC SoundFloor	28	2400	600	13.30
REDUC SoundFloor Extra	32	2400	600	16.70
REDUC SoundMat	12	1200	1000	15.50
REDUC Impact	6	10000	1250	4.20

Acoustic Performance

REDUC Product	Airborne DnT,w + Ctr	Impact L'nT,w	Impact ΔLw
REDUC Micro	50dB	50dB	22dB
REDUC Micro Extra	51dB	49dB	-
REDUC Strata	51dB	49dB	-
REDUC Strata Extra	53dB	48dB	-
REDUC Foundation (fitted as a structural floor)	51dB	47dB	-
REDUC Foundation Extra (fitted as a structural floor)	51dB	47dB	-
REDUC SoundFloor	47dB	54dB	19dB
REDUC SoundFloor Extra	47dB	54dB	19dB
REDUC SoundMat	-	-	29dB
REDUC Impact	49dB	48dB	19dB

NB The figures quoted above can only be expected when REDUC is used within recommended flooring constructions. All projects should be discussed with Hodgson & Hodgson prior to specification to ensure optimum acoustic performance is achieved.

**For Further Information on REDUC Contact:
Hodgson & Hodgson Acoustic Construction Division**

Crown Business Park, Old Dalby, Melton Mowbray, Leicestershire, LE14 3NQ
Tel: 01664 821810 Email: info@hodgsongroup.co.uk www.acoustic.co.uk